



Jordan fishwick

43 Glenside Drive, SK9 1EH
Guide Price £359,950

Glenside Drive Wilmslow SK9 1EH

Guide Price £359,950



A smart and well-presented three-bedroom home, ideally situated on the desirable Thorngrove Park close to excellent transport links and just a short walk from Wilmslow town centre and the train station. The accommodation comprises an entrance hall, downstairs WC, fully fitted kitchen with integrated appliances, and a spacious lounge with dining area and useful storage. Upstairs offers two generous double bedrooms, a single bedroom and a modern family bathroom. Externally, the property benefits from attractive front and rear gardens with a patio area, driveway parking, and a garage. Wilmslow town centre offers a wide range of amenities, which include a number of local shopping facilities, bars and restaurants. Wilmslow train station offers a direct service to London Euston and Manchester City centre and the location caters for many different needs. The property is well placed for easy access to the M56 and A34 for commuters to Manchester and the North West commercial centres and Manchester Airport is less than 20 minutes away. The property is perfect for first time buyers, investors and those buyers looking to downsize.



- A short stroll to Wilmslow Town Centre
- Garage
- Three bedrooms
- Private garden
- Thorngrove Park location



Energy Efficiency Rating		
	Current	Potential
Very energy efficient - lower running costs		
(92 plus) A		
(81-91) B		
(69-80) C		
(55-68) D		
(39-54) E		
(21-38) F		
(1-20) G		
Not energy efficient - higher running costs		
England & Wales	EU Directive 2002/91/EC	



GROUND FLOOR

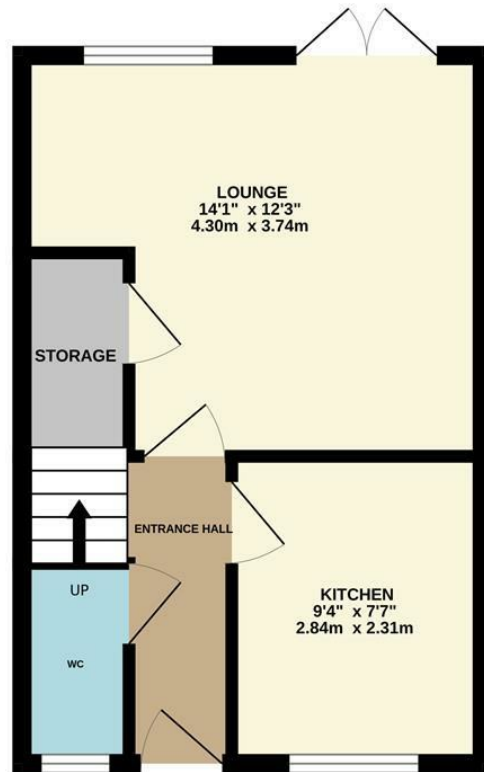

1ST FLOOR

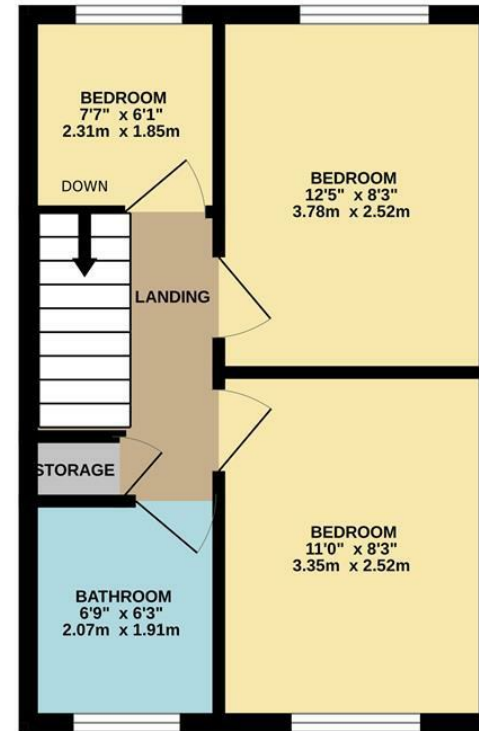

Measurements are approximate. Not to scale. Illustrative purposes only.
Made with Metropix ©2026



These particulars are believed to be accurate but they are not guaranteed and do not form a contract. Neither Jordan Fishwick nor the vendor or lessor accept any responsibility in respect of these particulars, which are not intended to be statements or representations of fact and any intending purchaser or lessee must satisfy himself by inspection or otherwise as to the correctness of each of the statements contained in these particulars. Any floorplans on this brochure are for illustrative purposes only and are not necessarily to scale.

Offices at: Chorlton, Didsbury, Disley, Hale, Glossop, Macclesfield, Manchester Deansgate, Manchester Whitworth Street, New Mills, Sale, Wilmslow and Withington

36-38 Alderley Road, Wilmslow SK91JX
01625 532000

wilmslow@jordanfishwick.co.uk
www.jordanfishwick.co.uk